

FBS-3 W204 W207 W212 W176 W246 W447

GK-5000

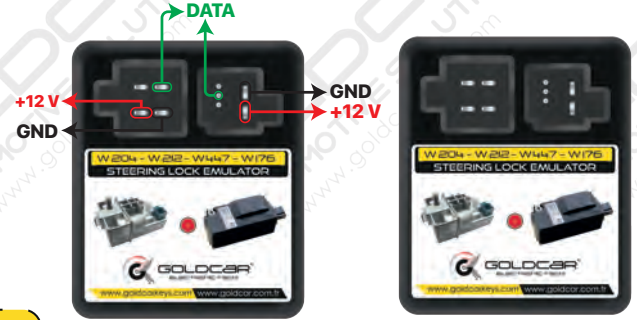

W204-W207-W212-W176-W246-W447

Mercedes W204 steering lock Fatal error is one of the most frequent problems in Mercedes Benz starting system for Mercedes W204, W207 & W212 from 2007 to 2014.

Mercedes Benz Dealer have to order new steering lock unit and program it which is too much costly and required long time of waiting, using this Mercedes Benz ELV Emulator, you can program it very easy & you can reprogram it to another vehicles once needed very easy.

Mercedes steering lock bypass emulator will make your job easier and faster, Mercedes W204 ESL bypass was never that easy, using Emulator W204 Mercedes it is safer and more durable than Mercedes W204 ELV repair since you will not get any Mercedes W204 ESL problem.

Mercedes W204 ESL Emulator Main Features:

- Mercedes W204/W207/W212/W176/W447 steering lock emulator is very simple and easy to use
- Mercedes W204/W207/W212/W176/W447 ELV steering emulator Support most types of Mercedes key programming devices
- Mercedes W204/W207/W212/W176/W447 emulator Can be reprogrammed several times
- Mercedes W204/W207/W212/W176/W447 ELV emulator light helps you to Determine the status of ELV programming

How to Use & Fix Mercedes W207 emulator?

- 1 - Unplug the ELV wire from the car steering lock unit.
- 2 - If vehicle steering lock is in lock mode steering lock must be removed from the car.
- 3 - Calculate Mercedes EIS Password using famous diagnostic tool. (VVDI, AVDI, etc.)
- 4 - Mercedes ESL Emulator programming must be done using famous diagnostic tool device.
- 5 - Connect the Mercedes ELV emulator to the car and start the car.

The Mercedes steering lock emulator is reprogrammable and can be reused again for another vehicles.



Mercedes Steering Lock Emulator Light Behavior

After programming ELV emulator Mercedes and connecting it to the car, or to the testing cables, insert the car key to the ignition switch.

- If the Emulator ELV Mercedes-Benz light turn green that mean programming is done perfectly, and the car is ready to start
- If the Mercedes EIS Emulator light turn red that mean programming procedures is not done well or the key you are using doesn't belong to the same EIS / EZS.
- If the Mercedes ELV emulator W204 light doesn't turn on you must check the power supply of the car or the cables

Mercedes Benz Steering Lock Emulator Supported EIS / EZS

- ELV Emulator Mercedes W204 EIS
- ELV Emulator Mercedes W207 EIS
- ELV Emulator Mercedes W212 EIS
- ELV Emulator Mercedes W176 EIS
- ELV Emulator Mercedes W246 EIS
- ELV Emulator Mercedes W447 EIS with steering lock

Mercedes ESL Emulator Supported Key Programming Devices

- Abrites AVDI
- CGDI MB
- Xhorse VVDI MB Tool
- DIAGSPEED
- Xhorse Keytool Plus
- AUTEL AURO

